

Section Control System R1.0



Assembly Instructions

- JAS4751A - Section Control Box
- JAS4785A - Tank Kit (per tank)
- JAS4786K - Monitor Kit

Romafa Section Control System

Equipment requirements before installing the Romafa Section Control:

1. You will need 30 Amp power supply at the rate controller installed (newer carts are factory installed)
2. John Deere Liquid Rate Controller Kit (JD Part # 0330PC)-includes Rate Controller, Main Harness, CAN Bus Terminator and In-cab foot switch or, Romafa Monitor/Controller Kit (JAS4786K).
3. John Deere Rate Controller Implement Height Sensor Kit (JD Part # PF90577) to be installed on seeding tool.

When using Romafa Section Control with a JD Liquid Rate Controller Kit (JD Part # 0330PC)

1. JAS0168A - Meter housing with individual run shut-off gates
2. JAS4719K - Ground Drive Clutch Mount Bracket 1900/1910 (TBT/TBH Ground drive Carts only)
3. JAS4785A - Actuator and Mounting Kit (one required per tank)
4. JAS4751A - Section Control Electrical System Box
5. JAS0331A - Romafa Section Control Main Harness for John Deere System
6. JAS4817A - CANBus Adapter Harness (TBT/TBH Ground and TBT Hydraulic Drive Carts only)
7. JAS4818A - CANBus Adapter Harness (TBT Ground and Hydraulic Drive Carts if CANBus needs to extend beyond cart onto Seeding Tool only)
8. JAS4819A - Rate Controller Master Switch By-pass Harness (TBH Hydraulic Drive Carts if not equipped with Master Switch wiring only)

When using Romafa Section Control with Romafa Monitor/Controller Kit:

1. JAS0168 - Meter housing with individual run shut-off gates
2. JAS4719K - Ground Drive Clutch Mount Bracket 1900/1910 (TBT/TBH Ground drive Carts only)
3. JAS4785A - Actuator and Mounting Kit (one required per tank)
4. JAS4751A - Section Control Electrical System Box
5. JAS4786K - Romafa Monitor Kit

INSTALLATION

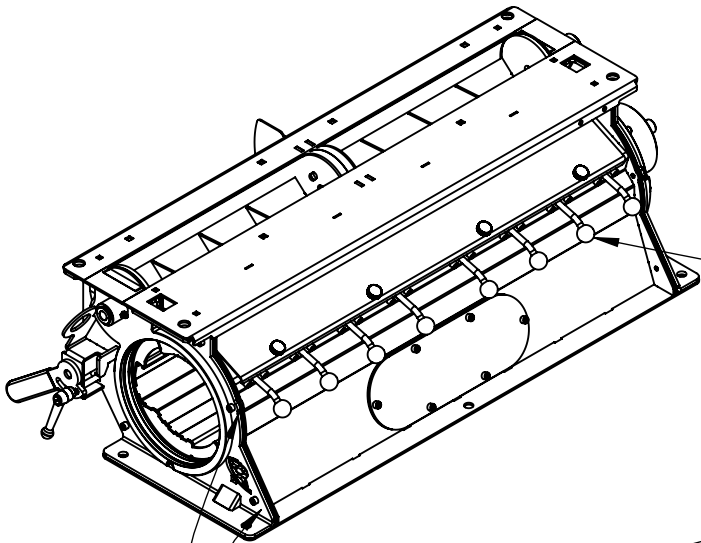

STEP 1

Remove the black knob from shut-off gate handle for each run that is to be controlled by the section control system.

STEP 2

Remove two bolts from each end of meter housing.

STEP 3

Install actuator mount plate on each meter housing

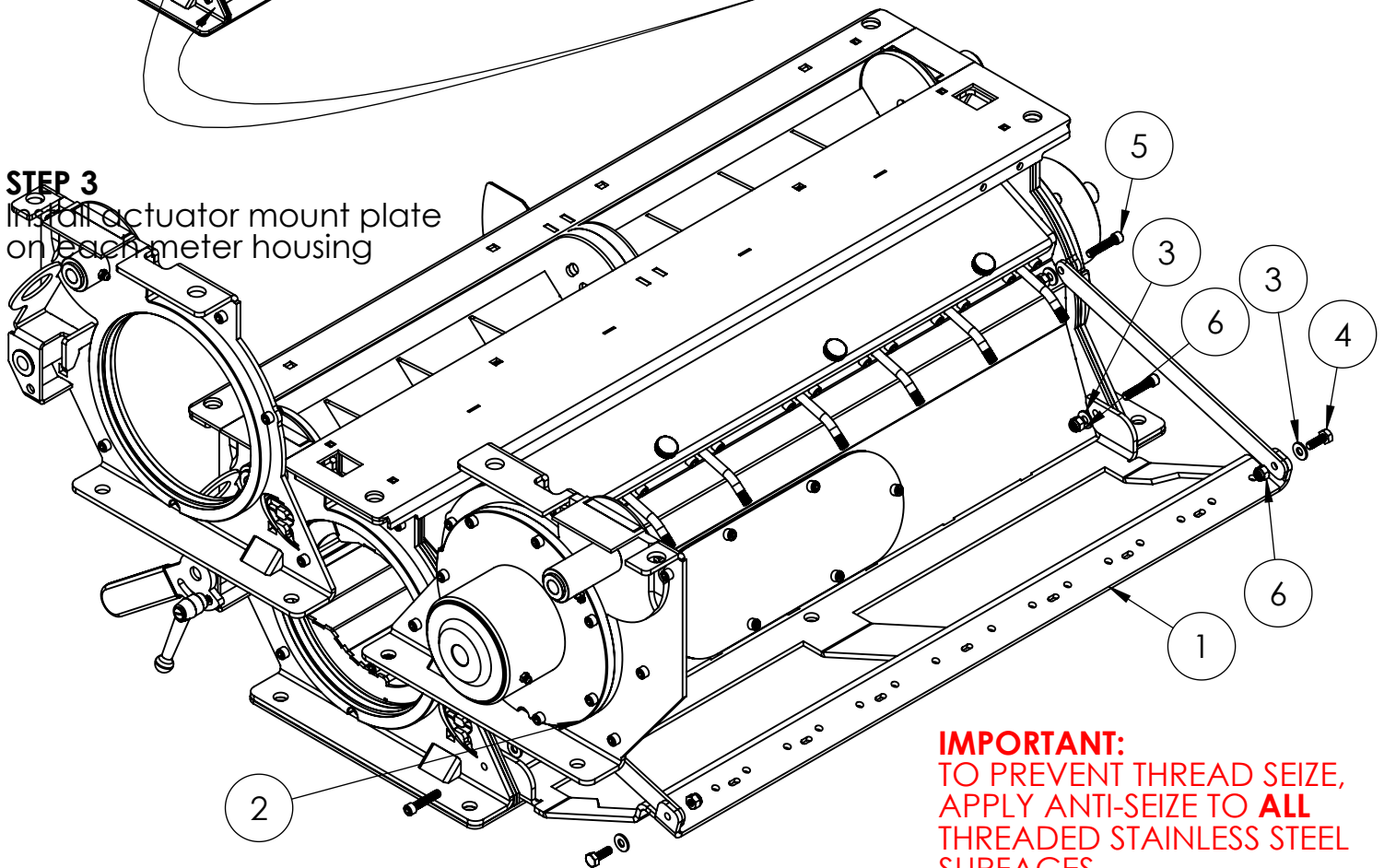

IMPORTANT:
TO PREVENT THREAD SEIZE,
APPLY ANTI-SEIZE TO **ALL**
THREADED STAINLESS STEEL
SURFACES.

ITEM NO.	PART NUMBER	DESCRIPTION	QTY.
1	JAS0213P	Actuator Mount Plate	1
2	JAS0214P	Support, Actuator Mount Plate	2
3	HW0029	1/4 x 5/8 OD Flat Washer SS	6
4	HW0058	1/4-20 x 3/4 Hex Bolt SS	2
5	HW0049	1/4-20 x 1-1/4 SHCS SS	4
6	HW0003	1/4-20 Nylon Locknut SS	6

STEP 4

Install the actuators.

JAS4785A

ITEM NO.	PART NUMBER	DESCRIPTION	QTY.
1	JAS4707A	Actuator Mount, Bracket Assem	1
2	JAS4766K	Actuator Mounting Bracket	8
3	JAS4787A	Actuator Harness	1
4	HW0020	5/16-18 Jam Hex Nut SS	8
5	JAS0216P	Clevis, Actuator Mount	8
6	SIPR-0062	1/16" R-Clip	8
7	HW0029	1/4 x 5/8 OD Flat Washer SS	8
8	T00233P	1/4" x 1.5" Clevis Pin, Stainless Steel	8
9	JAS4788A	Actuator Plug Assembly	8

Thread the clevis onto the gate handle till the inside of the clevis is flush with the end of the gate handle. Have clevis rotated so it points away from meter housing. Tighten jam nut down against clevis.

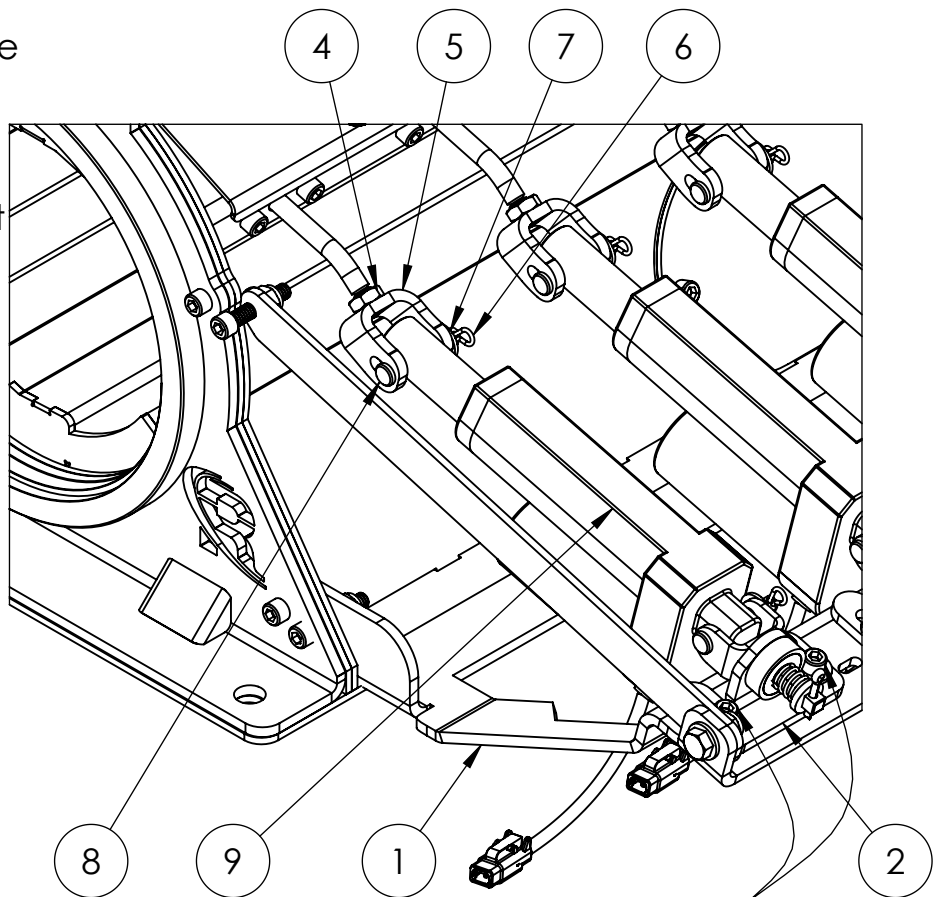

APPLY ANTI-SEIZE TO ALL THREADED STAINLESS STEEL SURFACES.

IMPORTANT:
Do not tighten bolts at this time

STEP 5

Install the Romafa control box on the side of the cart opposite the conveyor / auger, between the 1st and 2nd tank.

APPLY ANTI-SEIZE TO ALL
THREADED STAINLESS STEEL
SURFACES.

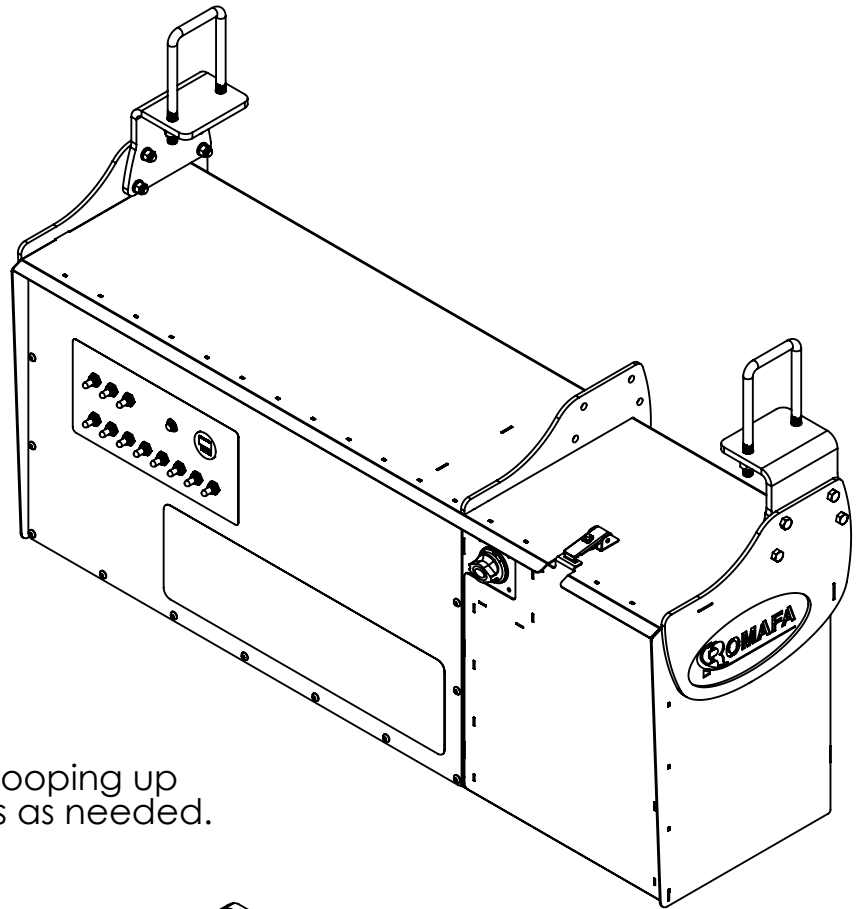

STEP 6

Route the wiring harnesses, looping up and securing excess harness as needed.

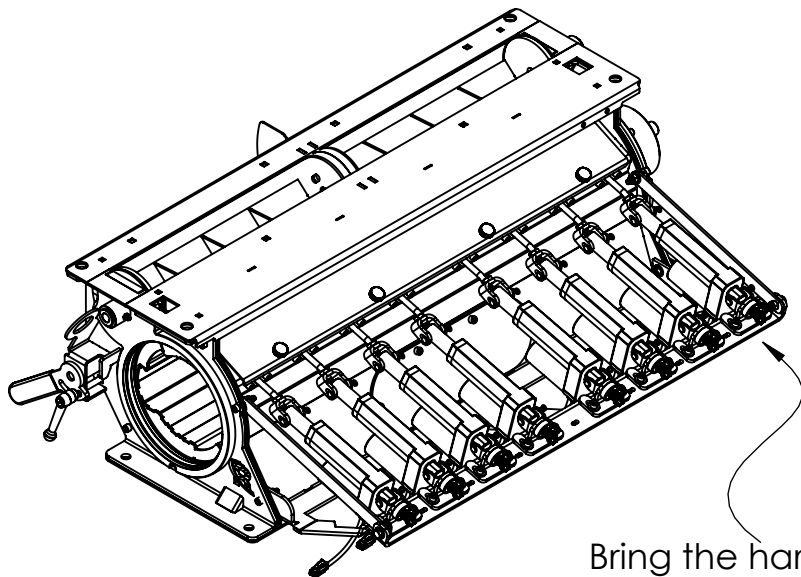

Bring the harness in underneath the actuator mount plate, using ties to secure the harness and actuator cords to the support bracket.

STEP 7

Adjust actuators. Follow these steps for each actuator.

1. Make sure bottom actuator mounting bracket is not tightened.
2. Using manual controls on control box, fully extend the actuator.
3. With meter roll removed, slide gate feeler gauge under gate inside the meter housing; then push in on the clevis, closing the gate down onto the gauge. (This ensures a small gap, preventing the actuators from jamming up)
4. With the feeler gauge snug between the gate and meter housing, apply gentle pressure on the actuator mounting bracket, pushing it in toward the meter housing. Holding it snug, tighten down the two bolts holding the bracket.

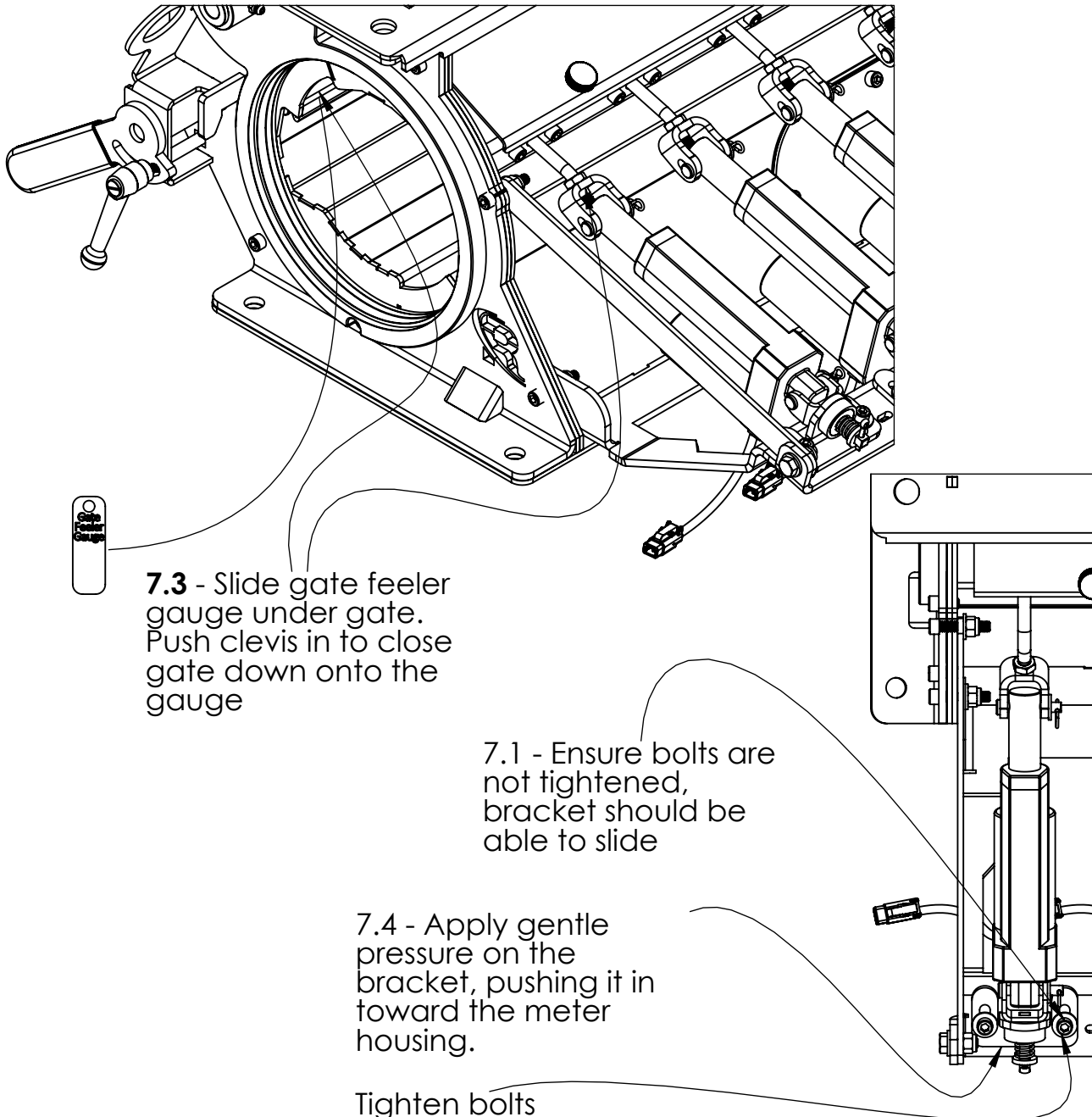

If equipped with ground drive remove the OEM clutch mount bracket and replace it with Romafa JAS4719K bracket. This is because the OEM bracket does not have clearance needed for Romafa section control.

